

**ABS APPROVED OFFSHORE  
ACCOMMODATION MODULES**

# ABS APPROVED OFFSHORE ACCOMMODATION MODULES

**TLS**  
*Offshore containers  
Special containers*

## A60 offshore accommodation module offering safe and comfortable living space for 1, 2, 3, 4 or 8 personnel

- Modules fitness as three stacking level manned during floating / elevating condition meeting weather criteria in addition to compliance with ILO/MLC.
- Linking kits are provided and these kits maintain the A60 integrity of the accommodation block and seals around the door frames providing a watertight barrier to the elements.
- The accommodation modules are suitable for 380V – 480V, 60Hz electrical supply, (a multi tap transformer is located within the module services area and a voltage selection switch allows multiple power connections) with socket outlets suitable for 240V.
- Each module comes fully equipped with its own HVAC system, fire and gas detection system (Dampers), sprinklers, power supply connections, PAGA/TV/Tel sockets and connections, fresh and sea water supply connections, black and grey water drainage pipes - all fitted as standard. Emergency electrical lighting.
- The modules are linkable and a central corridor runs the length of each accommodation level, access to each level is located at each end of the accommodation block. This negates the need to venture outside every time a worker needs to go from one module to another.
- The units can be stacked to form a multi-level accommodation complex. The modules are built using ISO corner blocks, which aid the installation and tie down to the vessel.





**Weight**

- Less than 17.5 Tons.

**Lifting**

- All modules, as well as being DNV certified, also have certified lifting eyes included in the design structure and each module is supplied with a certified sling. The units are designed for lifting on and off fixed platforms and other types of floating installations.

- Installation & Linking

- Each Module Comes complete with Twist Locks & Pads For Deck

**Mounting**

- Linking Kits for Structural, Mechanical & Architectural Linking of Modules.

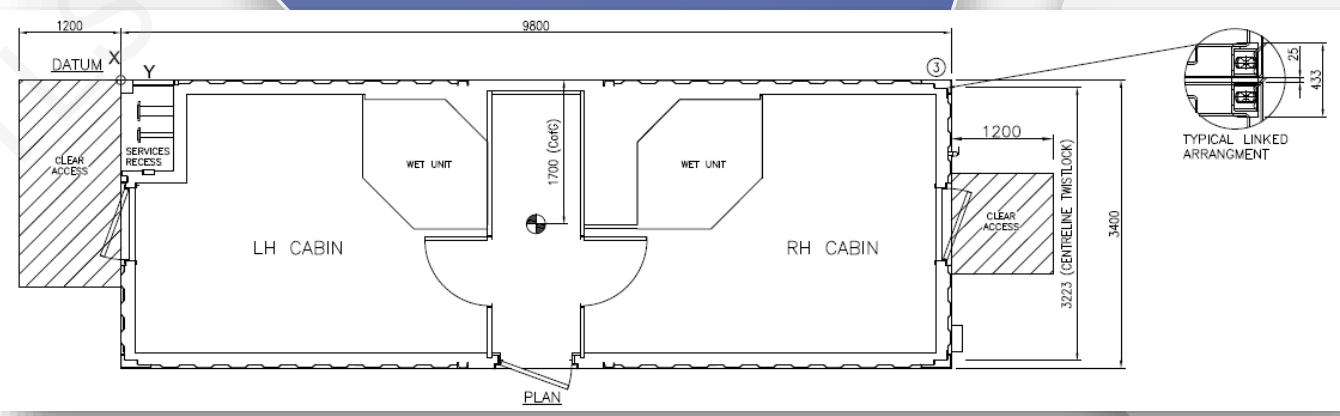
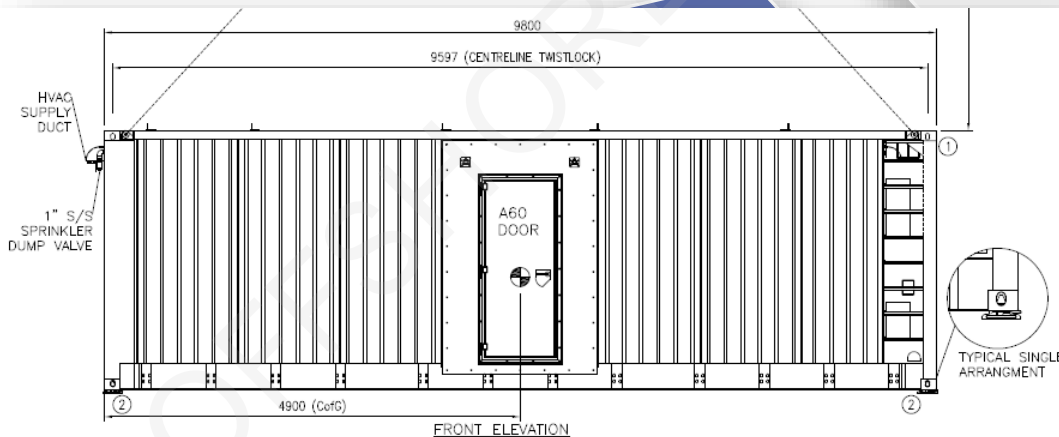

## Furnitures

- 2 x Double Bunks, Each Bunk comes with FR Mattress & Blackout Curtains, Integral Recessed book Shelf and Flexible LED Light With Switch at Source
- 1 x Desk With Upper Shelf and Integral Flexible LED Light, Double Socket, Data Outlet & HVAC Thermostatic Control and 32" LED TV on Sliding & Pivoting Support Arm
- 1 x Operator Chair on Lockable Gravity Castors
- 3 x Full Height Lockers With Hanging Rail, Shelves & 4 x Coat Hooks Fastened to Outside End Face
- 1 x Wall Mounted AC Unit With Thermostatic Control
- 1 x Ceiling Air Supply Grille With Thermostatically Controlled Duct Heater & Attenuator Within Supply Duct Run
- 1 x Double Socket For Cleaning Equipment
- 1 x Ceiling Recessed PAGA Speaker
- 1 x Ceiling Mounted Smoke Detector
- 1 x Ceiling Sprinkler Outlet
- 1 x Wall Mounted Fire Extinguisher
- 1 x A60 Window Integrated Into Escape Hatch
- 1 x Wet Unit With Shower, Toilet, WHB, Mirrored Storage Cabinet & Accessories

